



# BICYCLE ASSEMBLY INSTRUCTIONS

## STAVANGER

### INDEX

○	Dictionary . . . . .	2
○	Tool list . . . . .	4
1	Unpacking . . . . .	5
2	Stem & Handlebar . . . . .	6
3	Front wheel . . . . .	7
4	Set bike up . . . . .	9
5	Seatpost . . . . .	12
6	Saddle . . . . .	13
7	Angles . . . . .	14
8	Pedals . . . . .	16
9	Reflector . . . . .	17
10	All set up . . . . .	18

A new Pelago bicycle is packed pre-assembled in a box with most of the parts already installed.

The bicycle is packed in the box to prevent it from damage in shipping, and that's why some parts are not installed. Don't worry - assembling the bike is easy and soon you'll be riding!

These instructions are only guidelines for building up your new bicycle and there might be small variations with specific models. If you have any questions or do not understand something in the instructions, consult with your local dealer, bicycle shop or our web support.

This manual is not intended as a comprehensive use, service, repair or maintenance manual. Please see a dealer or professional bicycle service for all service, repairs or maintenance.



### MANUFACTURER

Pelago Mfg Ltd.  
Helsinki, Finland  
info@pelagobicycles.com  
TEL +358 (0)45 161 6847

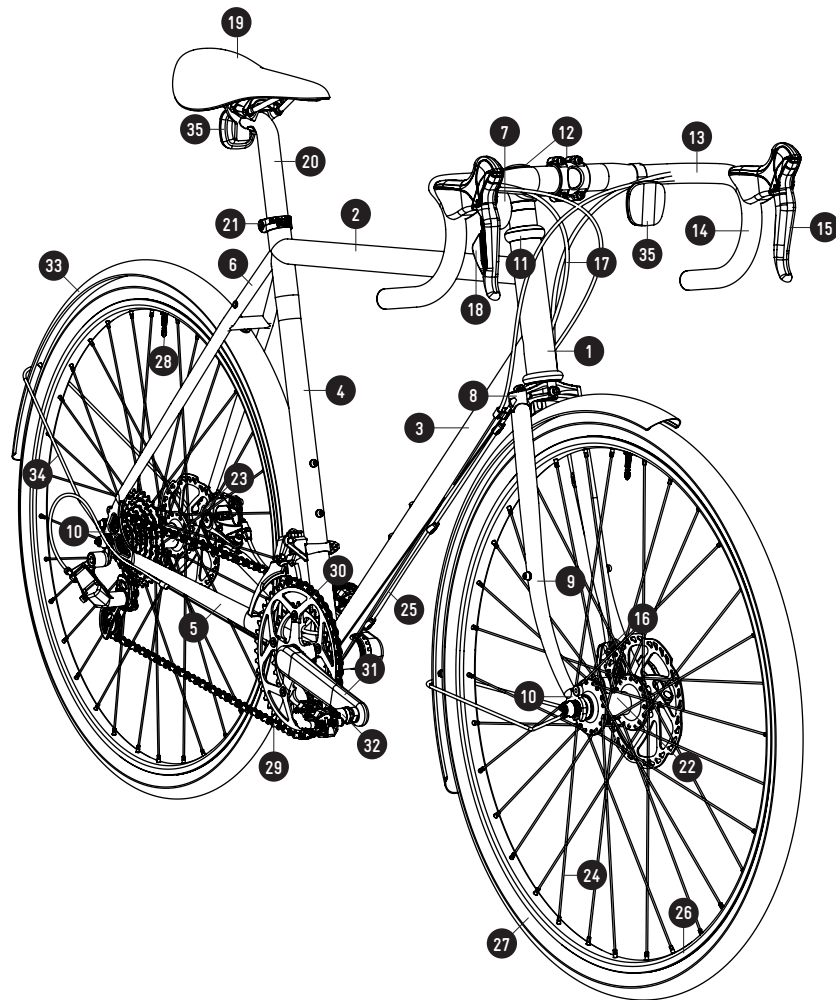

- |                  |                     |
|------------------|---------------------|
| 1 Head tube      | 19 Saddle           |
| 2 Top tube       | 20 Seat post        |
| 3 Down tube      | 21 Seat post clamp  |
| 4 Seat tube      | 22 Front hub        |
| 5 Chain stay     | 23 Rear hub         |
| 6 Seat stay      | 24 Spokes           |
| 7 Bell           | 25 Gear cable       |
| 8 Fork crown     | 26 Rim              |
| 9 Fork blade     | 27 Tire             |
| 10 Dropouts      | 28 Inner tube valve |
| 11 Headset       | 29 Chain            |
| 12 Stem          | 30 Front chainring  |
| 13 Handlebar     | 31 Crank arm        |
| 14 Grip          | 32 Pedal            |
| 15 Brake lever   | 33 Fender           |
| 16 Brake caliper | 34 Fender stay      |
| 17 Brake cable   | 35 Reflector        |
| 18 Gear shifter  |                     |

**TOOL LIST**

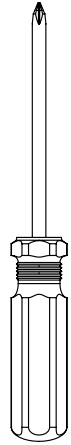

PHILLIPS  
SCREWDRIVER

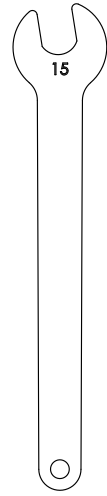

15  
PEDAL  
WRENCH



4 MM  
ALLEN KEY

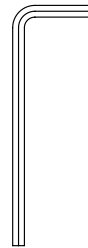

5 MM  
ALLEN KEY



6 MM  
ALLEN KEY

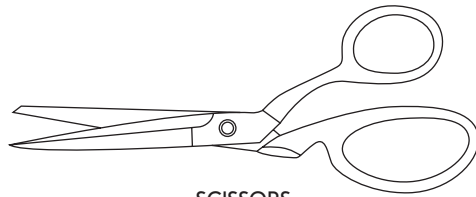

SCISSORS

**1 UNPACKING**

**NOTE** Be careful not to scratch paintwork or damage bicycle while unpacking.

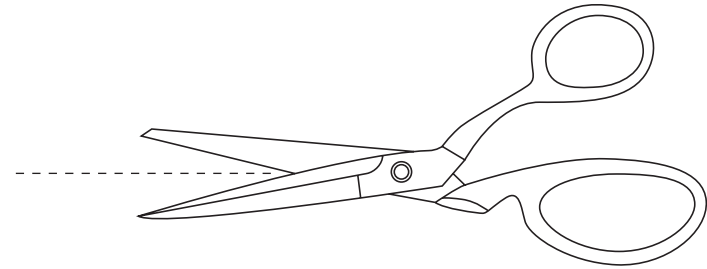

**SET UP BICYCLE ON THE BACKWHEEL AND FORK**

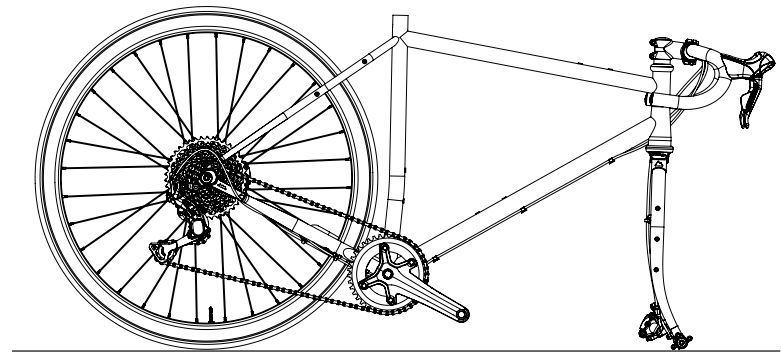

2

## INSERT HANDLEBAR TO STEM

**NOTE** You don't need to adjust the handlebar angle just yet!

### SECURING THE HANDLEBAR STEM

1. Turn the handlebar stem into straight position
2. Tighten the topcap bolt so that there is no slack on the headset and the handlebar can turn freely
3. Tighten the stem bolts on the back of the stem

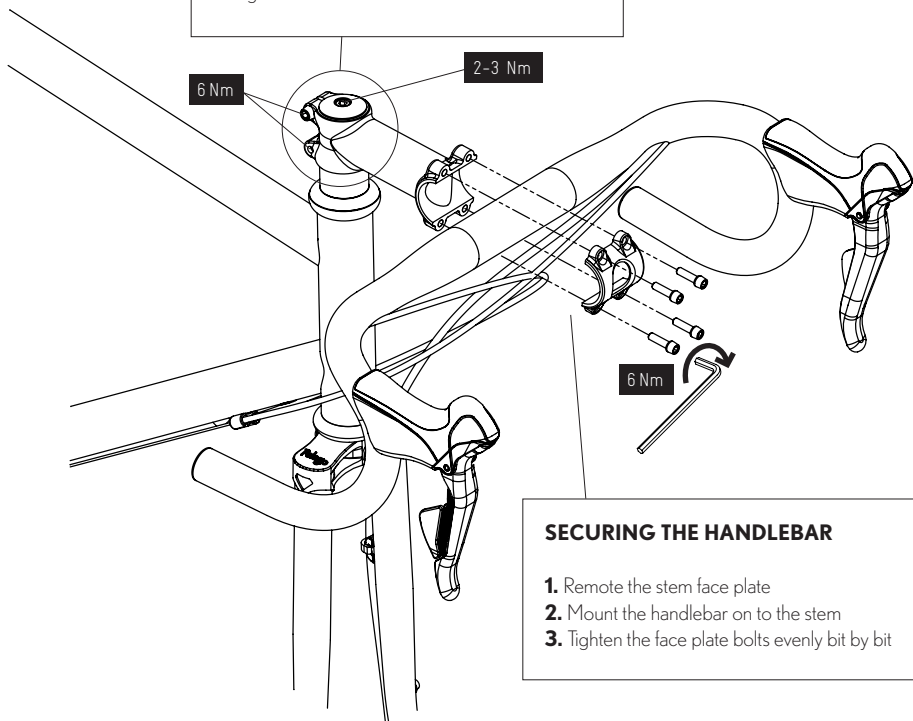

### SECURING THE HANDLEBAR

1. Remove the stem face plate
2. Mount the handlebar on to the stem
3. Tighten the face plate bolts evenly bit by bit

#### REQUIRED TOOLS

4 MM ALLEN KEY



3a

## FRONT WHEEL INSTALLATION



3b

## TIGHTEN FRONT WHEEL TO FORK

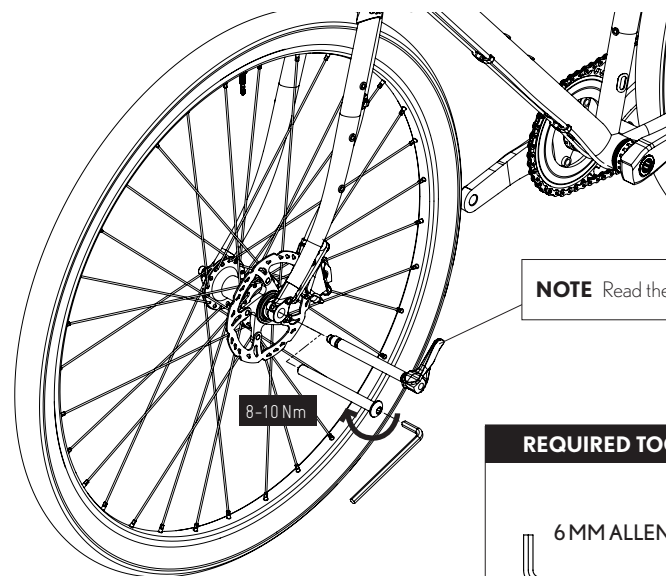

**NOTE** Read the instructions on part 3C

#### REQUIRED TOOLS

6 MM ALLEN KEY



3c

### OPEN/CLOSE THE QUICK RELEASE THRU-AXLE

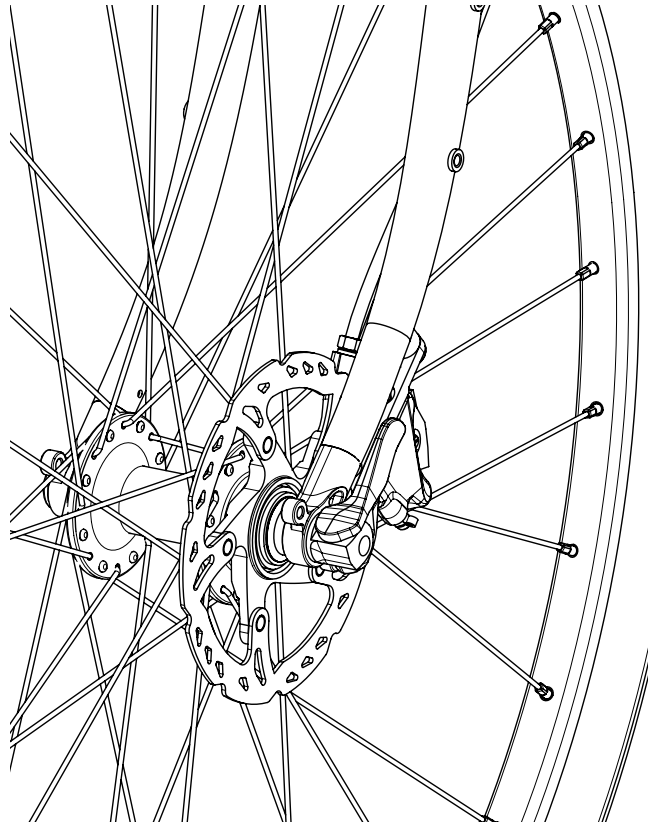

**CLOSING** Screw the axle in place. After the axle is fully inserted to the fork, secure the axle by turning the lever into closed position. You can adjust the levers tightening position by micro adjusting the knob in the other end of the axle

**OPENING** Open the quick release lever. Turn the axle counter clock wise to unscrew the axle. Pull the axle out.

**NOTE** In case of uncertainty of the thru axle closing or opening operation turn to your local professional bike mechanic.

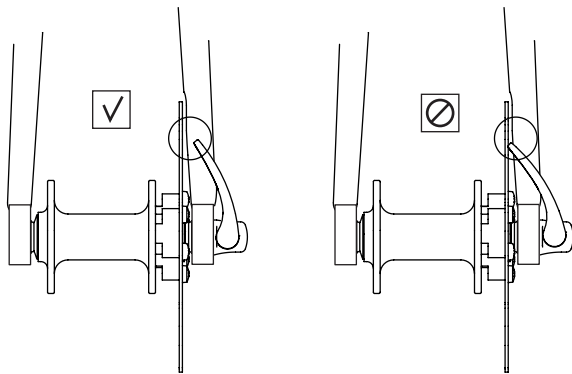

**NOTE** Make sure the quick release lever does not touch the disc brake rotor.

**NOTE** Turn the adjusting nut to the correct tightness and then close the quick release lever by hand. **DO NOT USE A TOOL.**

**NOTE** Make sure that the front fork does not interfere with the quick release lever. If the quick release lever is not closed properly, the wheel may fall of the bicycle and cause risk of serious injury.

4

### LAY THE BICYCLE AGAINST A WALL

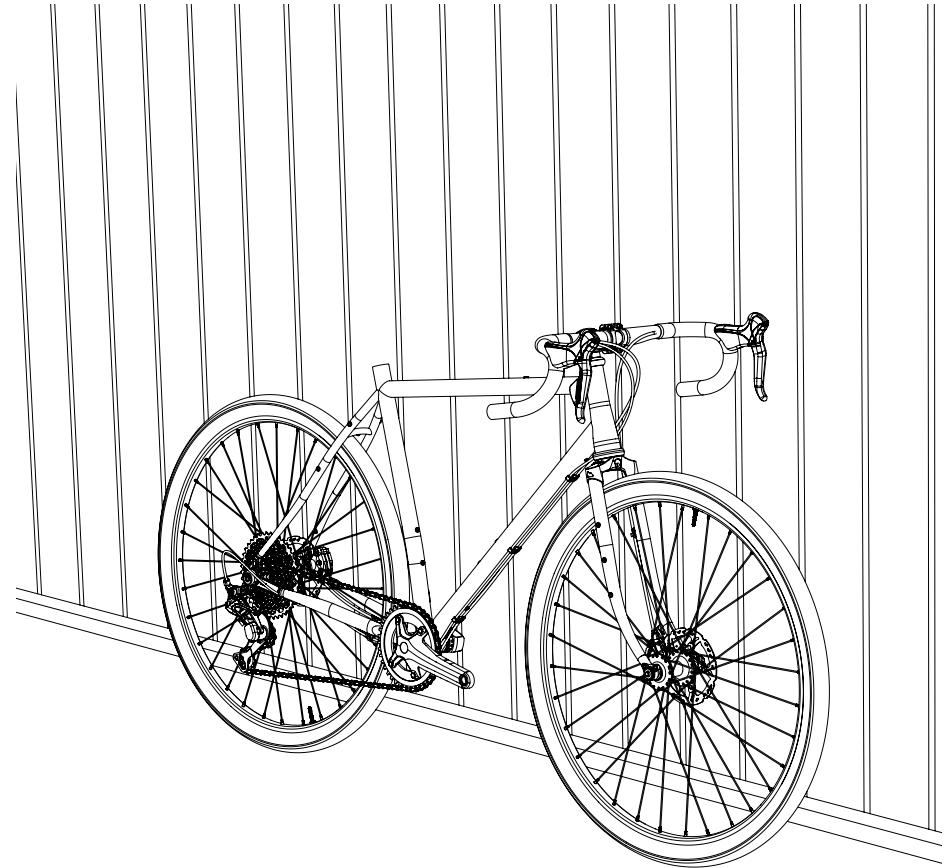

5

INSTALL SEATPOST CLAMP AND SEATPOST

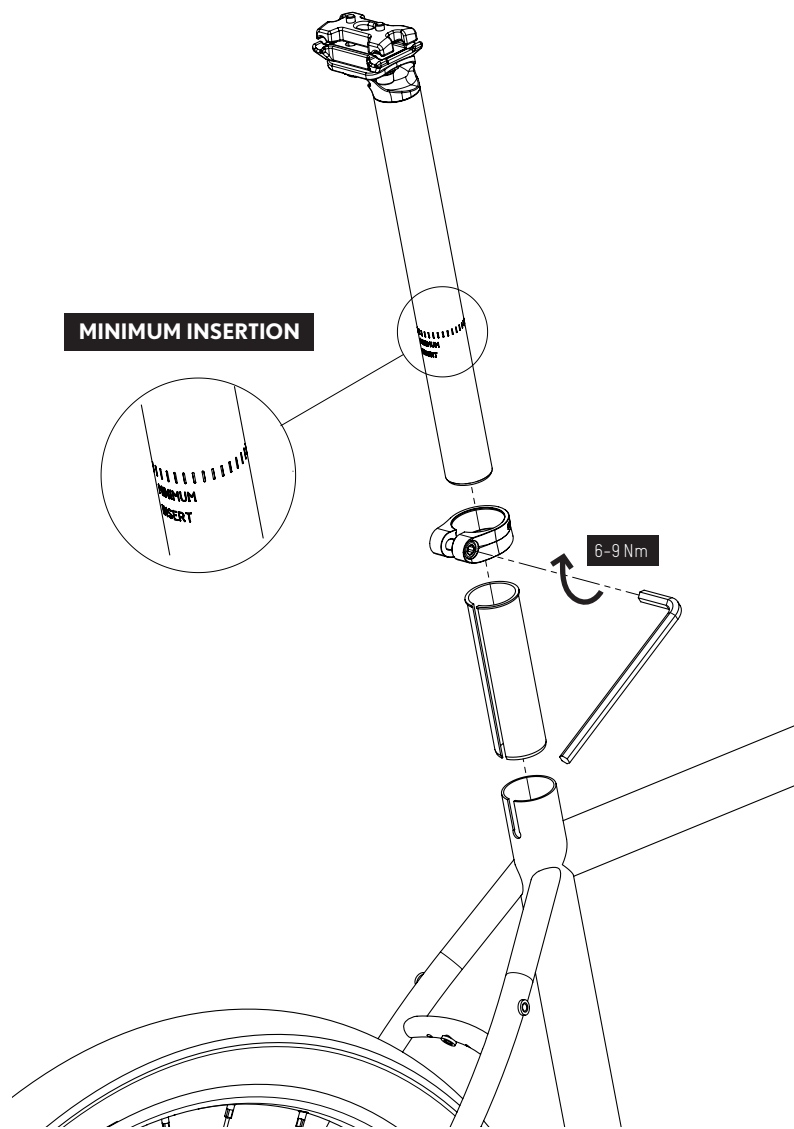

REQUIRED TOOLS

5 MM ALLEN KEY



6a

REMOVE SADDLE CLAMP

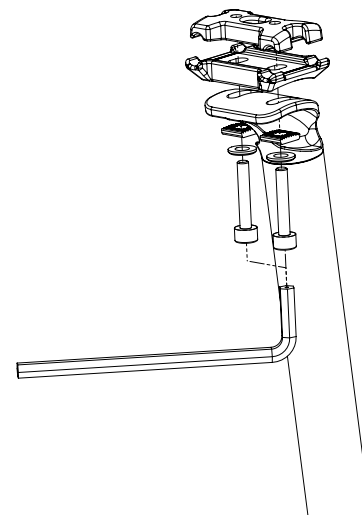

6b

INSTALL AND TIGHTEN THE SADDLE

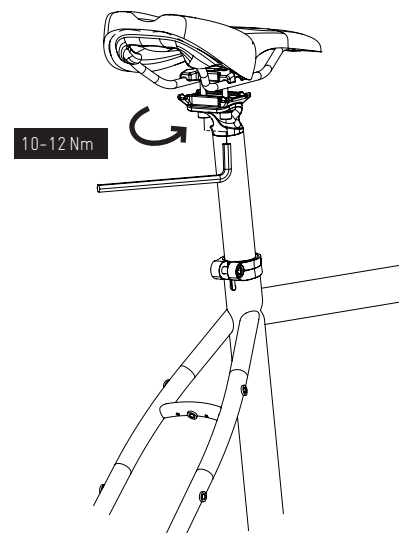

REQUIRED TOOLS

5 MM ALLEN KEY



10

11

7

CHECK SADDLE AND HANDLE BAR ANGLE

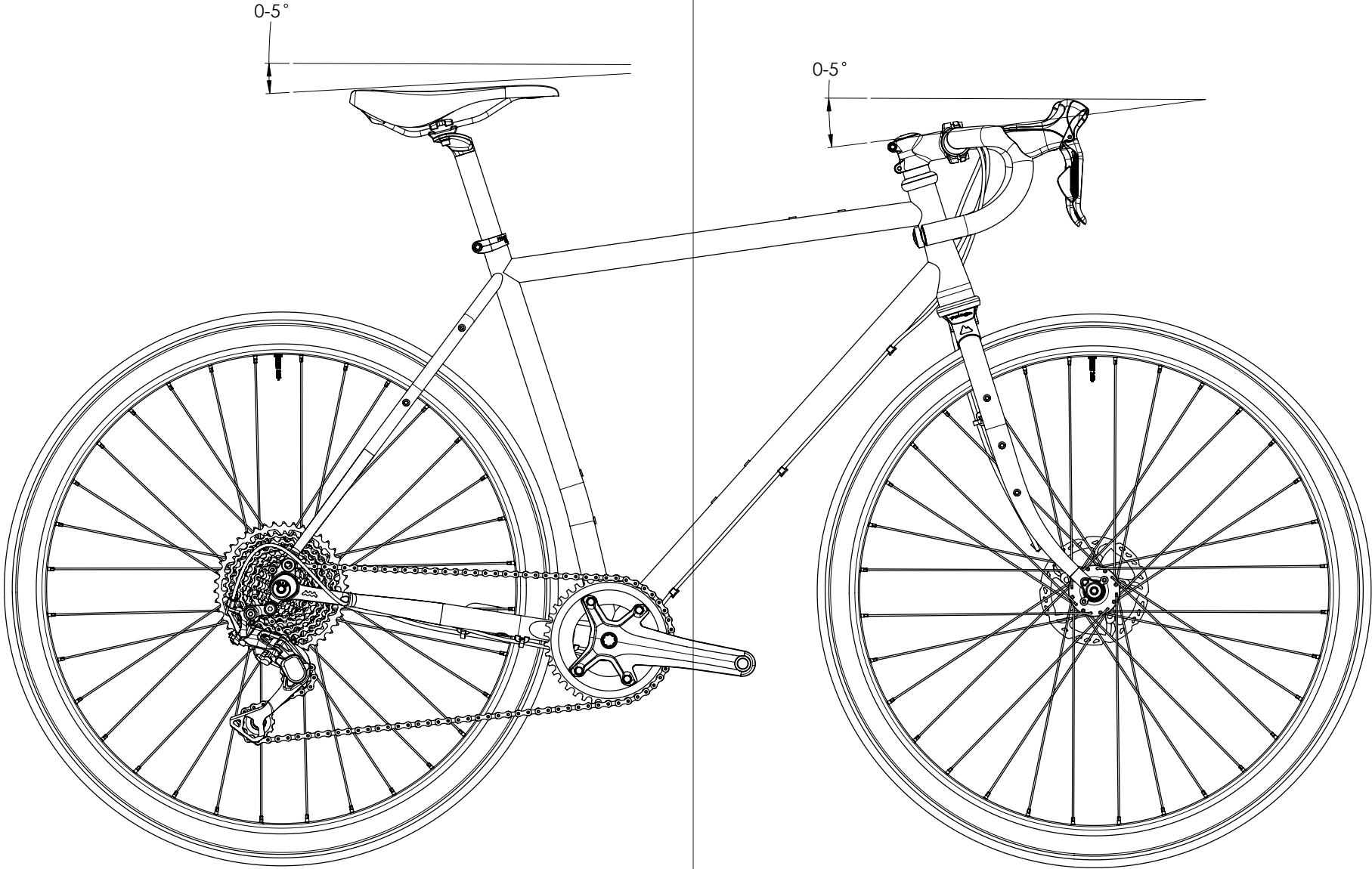

8

### PEDAL INSTALLATION

**NOTE: PEDALS ARE NOT INCLUDED AS A STANDARD**

#### DRIVE SIDE:

**NOTE**

Check for the **R**-marking on the pedal

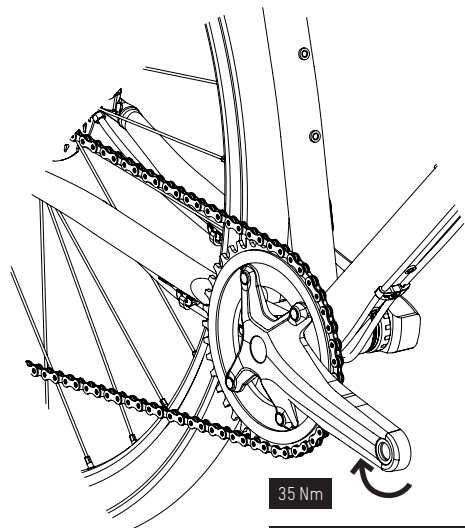
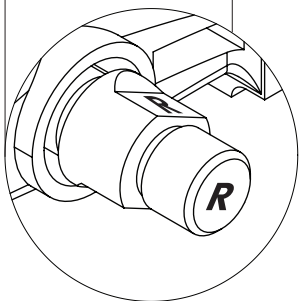

35 Nm

**TIGHTEN  
CLOCKWISE** ↻

#### NON DRIVE SIDE:

**NOTE**

Check for the **L**-marking on the pedal

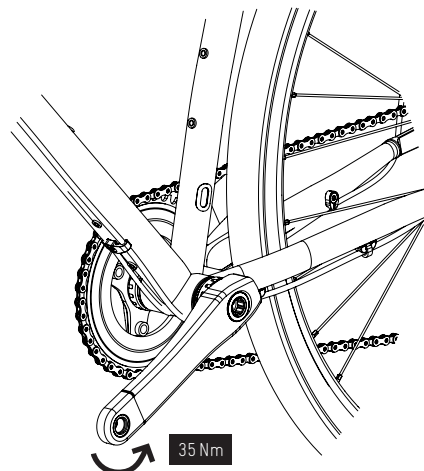
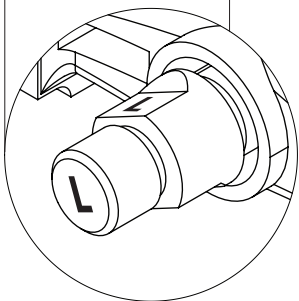

35 Nm

**TIGHTEN  
COUNTER  
CLOCKWISE** ↻

9

### INSTALL REFLECTORS

**NOTE** A bike model that is equipped with dynamo lights, the reflector is integrated in to the lights.

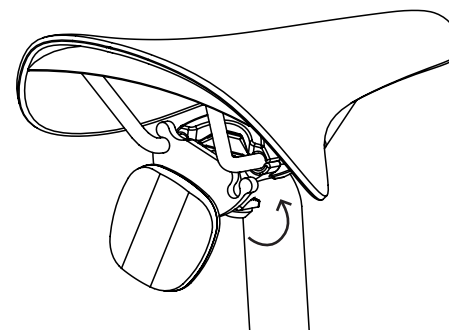
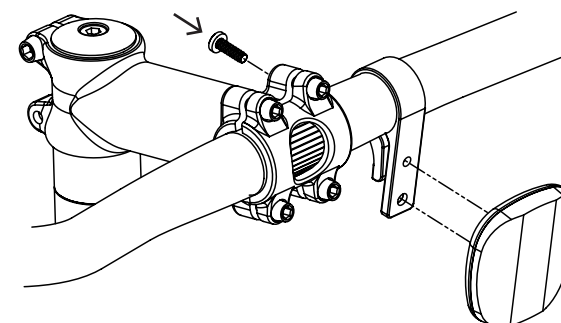
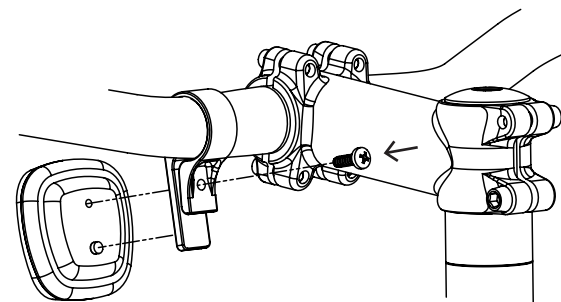

**NOTE** On a bike model that comes w/o fenders the rear reflector is assembled under the saddle.

#### REQUIRED TOOLS

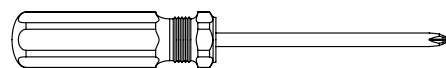

PHILLIPS  
SCREWDRIVER



## CONGRATULATIONS!

Your new Pelago bicycle is now assembled, but before riding remember to check the following important parts of your bicycle. It is important that all components are fastened to the correct torque and you understand the controls of your bicycle.

### Check brakes.

Make sure your brakes work correctly and you can react and stop quickly enough in traffic. (Owners manual 4.3 brakes p. 70-77)

### Check tyres.

Pump your tyres to the recommended pressure written on the sides of the tyres. (Owners manual 4.7 Tyres and tubes p. 86-91)

### Check gears.

Make sure your gears work correctly and you know how to use them. (Owners manual 4.4 shifting gears p. 78-82)

All the new components on the bicycle have a break-in period in which bolts get a bit looser, brake cables stretch and get looser and generally all parts set-in. Remember to take your bicycle to your local dealer or bicycle shop for a **first service** after about a month of getting the bicycle.

This manual is only a guideline to assemble your bicycle, so remember to read through the owners manual for more specific instructions about your Pelago bicycle.

**If you are unsure or have even the slightest doubt about understand something in these instructions, we urge you to take your bicycle to a professional bicycle mechanic.**



**Pelago**<sup>®</sup>  
BICYCLES